

Adding A YouTube Video To Your Course

Moodle makes it very easy to include YouTube videos to your course.

YouTube videos are best added in 'Labels' or 'Pages' (See other InfoSheets for the basic instructions on how to create these)

As an example, this InfoSheet will demonstrate how to add a video to a 'Label'.

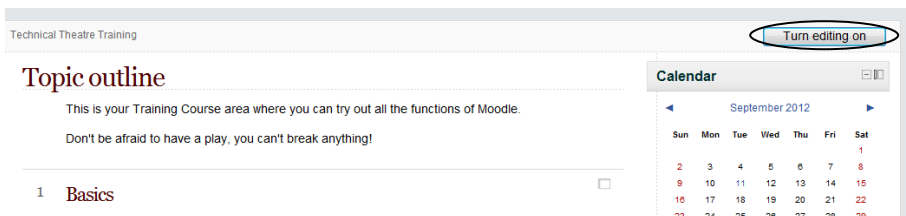

Start by clicking on the 'Turn editing on' button (top right of the screen)

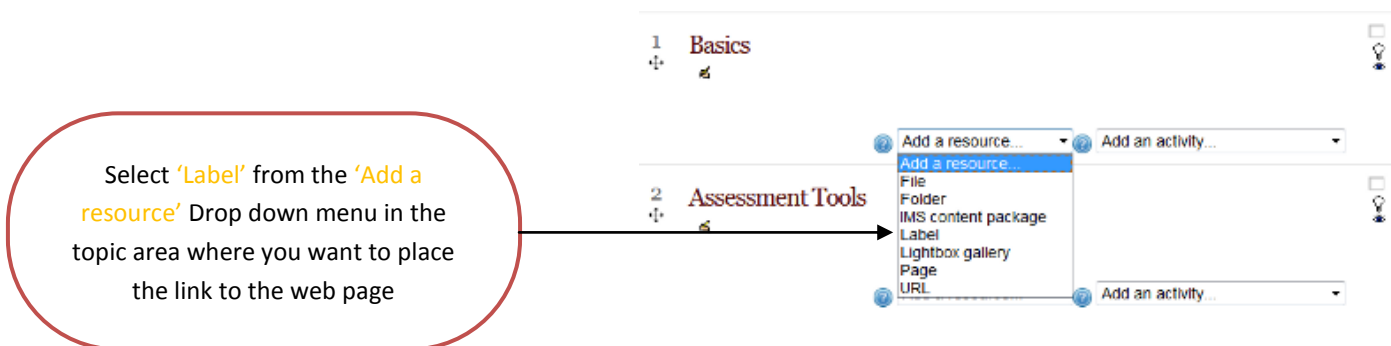

Select 'Label' from the 'Add a resource' Drop down menu in the topic area where you want to place the link to the web page

This will open the 'Add a new Label' screen.

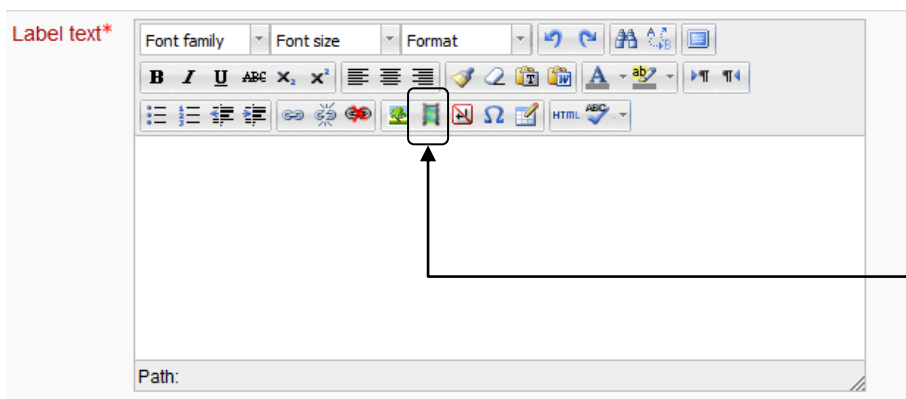

To add the video to the label, click on the 'Moodle Media' button, which looks like a film strip, in the usual editor.

The Insert/edit Media dialog box will open.

Click on the 'Find or upload a sound, video or applet...' button

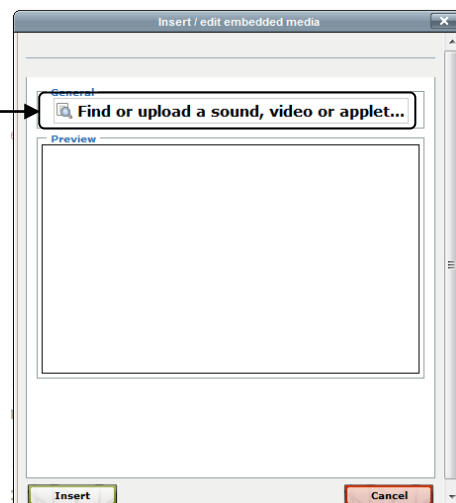

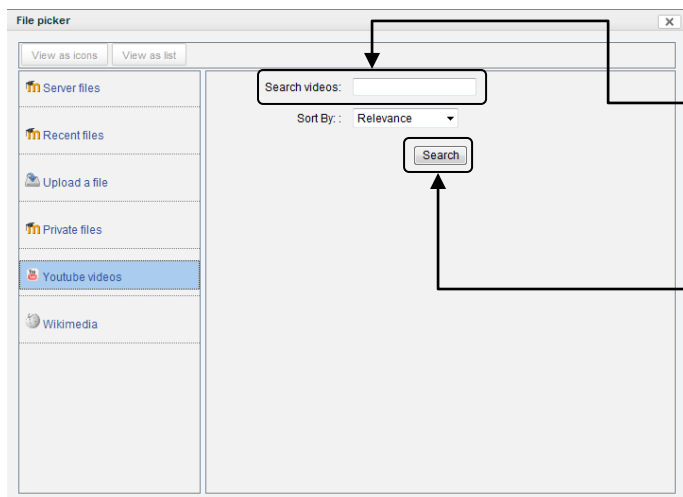

The 'File picker' dialog will open.

Click on 'YouTube videos' and then enter your search words e.g. "Design Realisation GSMD" into the 'Search video' box.

Pressing the 'Search' button will return a list of the videos, including thumbnail images, that match your search criteria.

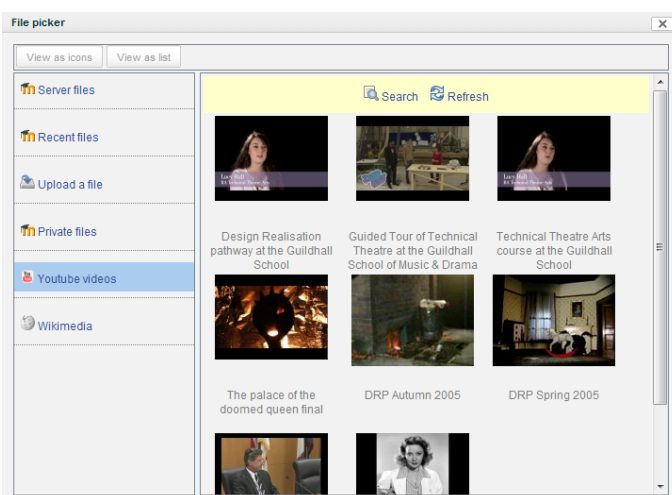

To select one, simply click on it and then click on 'Select this video' on the next screen.

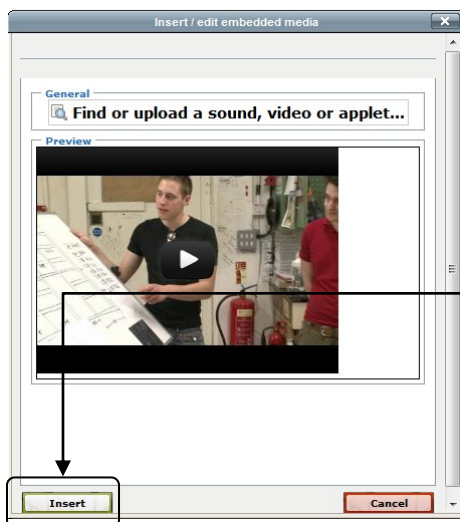

You will then be given an opportunity to preview the video, by clicking on the 'Play' icon on the video thumbnail.

If you are happy with the video, just click on the 'Insert' button to add it to the label.

If it isn't what you were looking for you can click on 'Find or upload ...' and search again.

The video will just appear as a text link in the editing box.

Don't worry about this, it will display as a video in the label when you have finished editing it and saved it.

You can now add any text that you want to appear along with the video in the 'Label text' box.

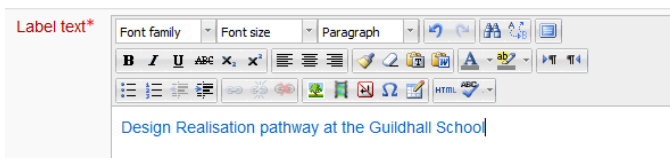

When you have completed editing scroll down to the bottom of the page and click 'Save and return to course'.

The video will now be 'embedded' in the course page.

N.B. If you are going to use a number of videos it is probably best to add each one to a 'Page' rather than a 'Label'